



**INTERNATIONAL CASTING SPORT FEDERATION**

**International Tournament Rules for Casting sport**

**ICSF Edition:2026**

Print 2026

**INTERNATIONAL CASTING SPORT FEDERATION (ICSF)**  
**International Tournament Rules for Casting sport**  
**Edition: 2026, Print 2026**

---

<b>CONTENT</b>		<b>Page</b>
<b>I</b>	<b>Tournaments</b>	4
<b>II</b>	<b>Participation rules</b>	4
<b>III</b>	<b>Changing the nationality of the caster</b>	5
<b>IV</b>	<b>Events</b>	5
<b>V</b>	<b>Competition Rules</b>	6
	Event 1 Fly Accuracy	6
	Event 2 Fly Distance Single Handed	8
	Event 3 Spinning Accuracy Arenberg-Target	9
	Event 4 Spinning Accuracy Skish-Targets	10
	Event 5 Spinning Distance Single Handed	11
	Event 6 Fly Distance Double Handed	12
	Event 7 Spinning Distance Double Handed	12
	Event 8 Multiplier Accuracy	13
	Event 9 Multiplier Distance Double Handed	13
	Event 10 Trout Distance for Casting sport	14
	Event 11 Salmon Distance for Casting sport	15
<b>VI</b>	<b>Deviations for Lines and Plugs</b>	16
<b>VII</b>	<b>General Rules for Fly-Casting Events</b>	16
	1 Casting techniques	16
	2 Illegal casts (casts that score zero)	16
	3 Broken or faulty tackle	17
	4 Determining results	17
<b>VIII</b>	<b>General Rules for Spinning and Multiplier Events (plug events)</b>	18
	1 Casting techniques	18
	2 Illegal casts (casts that score zero)	18
	3 Defect of tackle	19
	4 Determining results	19
<b>IX</b>	<b>Conduct of the Caster</b>	20
<b>X</b>	<b>Tackle control</b>	20
<b>XI</b>	<b>Official Record Cast</b>	21
<b>XII</b>	<b>Evaluation of the separate Events</b>	22

<b>XIII</b>	<b>Rules for Individual, Combinations and Teams scoring</b>	22
<b>XIV</b>	<b>Rules for Team competition</b>	23
<b>XV</b>	<b>Number of Winners</b>	23
<b>XVI</b>	<b>Determining the Winners</b>	24
	1. Winner	24
	2. Finals	24
	3. Proceeding in the accuracy events	24
	4. Proceeding in the distance events	25
	5. Same level of points in the accuracy events	25
	6. Same level of points in the distance events	25
	7. Same level of points in the combinations	25
	8. For Youth	25
<b>XVII</b>	<b>Determining the Winners of the Teams</b>	26
<b>XVIII</b>	<b>Titles</b>	26
<b>XIX</b>	<b>Hail the Winners</b>	27
<b>XX</b>	<b>Tournament committee</b>	27
<b>XXI</b>	<b>Meeting of heads of delegations</b>	28
<b>XXII</b>	<b>The Jury</b>	28
<b>XXIII</b>	<b>Protests</b>	29
	1 Protests against violation of tournament rules	29
	2 Protests against violation of rules concerning the conduct of the tournament	29
<b>XXIV</b>	<b>Other Rules</b>	30
	1 Duties and conduct of the judges	30
	2 Duties and conduct of the international chief judge:	30
	3 Conduct of trainers and coaches	31
<b>XXV</b>	<b>Groups and group leaders</b>	31
<b>XXVI</b>	<b>Other responsibilities of the arranging organisation</b>	32
	1 Start list	32
	2 Insurance	33
<b>XXVII</b>	<b>Starting fees</b>	33
<b>XXVIII</b>	<b>Drawings</b>	34-46

***INTERNATIONAL RULES FOR CASTING SPORT TOURNAMENTS***  
***International Casting Sport Federation (ICSF)***  
***Edition 2025***

**I. TOURNAMENTS**

The ICSF organizes World and Continental Championships, as well as sanctioned international competitions for Men, Ladies, Youth, and Masters, in accordance with these International Casting Tournament Rules.

There are no age restrictions for participation in the men or lady's class.

Classes:

- Men
- Ladies

Master:

- Master Men
  - I. (55) A caster from the calendar year they turn 55 until the end of the calendar year they turn 66.
  - II. (67+) A caster from the calendar year they turn 67 and onward.
- Master Ladies
  - I. A caster from the calendar year they turn 55 and onward.

Youth:

- U16 (Boys, Girls). A caster up to and including the end of the calendar year in which they turn 16.
- U23 (Boys, Girls). A caster up to and including the end of the calendar year in which they turn 23.

**II. PARTICIPATION RULES**

All National Organizations in good standing organized in the ICSF may take part at ICSF World and Continental Championships and at all sanctioned International Tournaments.

The list of tournaments for casting sport season will be published by ICSF Board before the season starts.

Excluded are organizations and their individual athletes that have lost their membership or have not paid the ICSF membership fee. Application and notice of participation to World and Continental Championships by National Organizations may be made up to 2 months before the Championships.

Names of the participants must be submitted by National Organizations at least 4 weeks before the World and Continental Championships. The final changes are possible to make at the meeting of the delegation leaders before the competition.

Changes because of sudden sickness of participants have to be tendered with written notice to the

Tournament Committee (organization committee) before 1 hour in advance of Tournament Opening. (Point of time as stated in the invitation)

All nations and participants are obliged to follow the ICSF anti-doping rules, which are in compliance with WADA (World Anti-Doping Agency).

### **Result determines a title.**

The highest number of participants at World and Continental Championships per nation is 9 men, 5 ladies. Reserves are allowed.

At all World and Continental Championships each nation may have a maximum of 6 named men in the events 1 to 9, and 3 named ladies in events 1 to 5+8+9+11.

From these named participants 4 men and 2 ladies are to be designated for the Team Competition. For the events 8 and 9 could be changed 3 named men and 2 named ladies per nation.

At all Youth World and Continental Championships each nation may have a maximum 6 U16 boys , 3 U16 girls in the events 1 to 5 +10 and 6 U23 boys, 3 U23 girls in the events 1 to 5 +11.

From these named participants 4 boys and 2 girls are to be designated for Team Competition.

World or Continental Championships can only be carried out if in the Men division at least 6 nations and in the divisions of the Ladies 4 nations take compete.

World or Continental Championships can only be carried out if in U16 and U23boys and U16 and U23 girls at least 4 nations take compete.

### **III. CHANGING THE NATIONALITY OF THE CASTER**

Casters, changing their nationality and their national organization are barred from any International Tournaments for one year. The change must be reported in each case to the ICSF new admittance must be applied for, by the ICSF when the year has passed. Such a new admittance is only possible if the caster has obtained his new nationality or makes the application plausible.

### **IV. EVENTS**

#### **Men's division , Masters I, Masters II**

Event 1	Fly Accuracy
Event 2	Fly Distance Single Handed
Event 3	Spinning Accuracy Arenberg Target
Event 4	Spinning Accuracy
Event 5	Spinning Distance Single Handed
Event 6	Fly Distance Double Handed
Event 7	Spinning Distance Double Handed
Event 8	Multiplier Accuracy
Event 9	Multiplier Distance Double Handed

#### **Ladies division , Master Ladies**

Event 1	Fly Accuracy
Event 2	Fly Distance Single Handed
Event 3	Spinning Accuracy Arenberg Target
Event 4	Spinning Accuracy

Event 5	Spinning Distance Single Handed
Event 8	Multiplier Accuracy
Event 9	Multiplier Distance Double Handed
Event 11	Salmon distance for Casting sport

### **U16 division girls and boys**

Event 1	Fly Accuracy
Event 2	Fly Distance Single Handed
Event 3	Spinning Accuracy Arenberg Target
Event 4	Spinning Accuracy
Event 5	Spinning Distance Single Handed
Event 10	Trout Distance for Casting sport

### **U23 division girls and boys**

Event 1	Fly Accuracy
Event 2	Fly Distance Single Handed
Event 3	Spinning Accuracy Arenberg Target
Event 4	Spinning Accuracy
Event 5	Spinning Distance Single Handed
Event 11	Salmon Distance for Casting sport

## **V. COMPETITION RULES**

**If possible, all courts are to build with the wind from the back.**

### **Event 1 Fly Accuracy**

- Rod: Ordinary one-handed fishing rod, maximum length 3.00 metres. Standard rings or guides.
- Reel: Standard fly-fishing reel, or self-made reel corresponding to standard. The reel has to be fastened to the rod; the line has to be fastened to the reel. The reel must carry all backing, the fly line including the leader.
- Line: Only fly-fishing line or similar line approved by the ICSF, ( see Approved Fly lines file ) minimum length 13.5 metres. Lines with metal and similar inlays are prohibited. Backing is unrestricted. The replacement of the tip of the fly line must be of the same material and the same colour.
- Leader: Minimum length 1.80 metres. The leader must be of a different material than the fly-line. The tip of the leader should be minimum 30 cm long and max. diameter 0,50 mm. Colour: good visible like yellow, orange, neon green, black, not transparent.
- Fly: Any standard tournament fly, without hook, approved by the ICSF.  
Any standard tournament fly, size 10, without hook, approved by the ICSF .( invalid since 1.1.2027)  
 Min. overall length of the fly – 15mm valid . since 1.1.2027  
 Max . overall length of the fly – 25mm , since 1.1.2027  
 Min. wire body length – 13mm , since 1.1.2027  
 Hackle diametres 16-20mm, to be tied in approved dry-fly style and white, yellow , red or

other highly visible reflective color. Before starting the event, the caster has to show the fly to the judge who decides if the fly is correct or not. In case of loss, flies can be replaced in an unrestricted number.

Platform: Minimum size 1.50 metres long and 1.20 metres wide, 0.50 metres height.

Targets: 5 flat water targets, 0.60 metres diametres, made from plastic or metal, with turned edge 3 cm high. Colour: dark - black, green, blue or brown, filled with water.

Court: Disc no 1 to the left of the caster. 8 metres from the upper middle front edge of the platform. Disc no 5 to the right, 13 metres from the upper middle front edge of the platform. Disc 2, 3 and 4 are on a straight line between no 1 and no 5. Disc no 3 is always placed directly in front of the platform. All distances to the targets are to be measured from the upper middle front edge of the platform to the centres of the target discs. Distance between the centres of the target discs has to be 1.80 metres.

#### Dry Fly

Round: Caster must start with fly in hand and rod-length fly-line, (no loose fly-line at reel) leader not included. If the line is not pulled in at rod-length, the judge will ask the caster to correct it. After a second demand the caster will be disqualified for this event.

Dry fly casting one attempt at time on each target in the following order: 3 - 1 - 4 - 2 - 5 - 3 - 1 - 4 - 2 - 5. At least one false cast shall be made between each score or lay of the fly. All ten targets have to be cast to in the consecutive order given or as many as time permits. Fly line may only be shortened or lengthened during false casting, with rod in motion, no stripping of the line from the reel allowed when rod is not in casting motion. Improper strip or shortening of the line shall make the next cast scoring 0 points.

Casting contrary to regulations (such as to lay down or repeatedly touching the ground with the leader or the fly line) the caster will be once warned on each target. If the caster ignores the warning the caster gets scored zero.

#### Wet Fly

Round: Having completed the dry fly round, the caster pulls the fly line back into level with disc no 1. Then the caster makes two rounds, one wet fly cast at a time on each target in consecutive order 1 - 2 - 3 - 4 - 5 - 1 - 2 - 3 - 4 - 5.

Line may be pulled in to shorten length between targets no. 5. and no. 1., but no blind or false casting allowed between casts on targets.

Casting: Should the fly, caused by bad floor or grass conditions, during wet fly round, hang, is it up to the international judge to decide if the caster should be given one more try.

Time: Time limit 5 minutes and 30 seconds.

Score: Each hit in target scores 5 points. Maximum score 100 points.

The inner part of the edge of the discs to be counted as the target and will score 5 points.

General: During dry fly- and wet fly-rounds the caster must stand with at least one foot directly adjacent to the front of the platform.

**Event 2**      **Fly Distance Single Handed**

Rod: One-handed fly rod, maximum length 3.00 metres.

Reel: Any reel. Reel fastened to rod; line fastened to the reel. Reel to carry all backing the whole fly line including the leader.

Line: Fly line approved by the ICSF. ( see Approved Fly lines file)

Men, U23 Boys and Master Men fly line:

Min length 13.50 m. Max length 15,6m . Max weight 38 gram.

Without tolerances

Ladies, U23 Girls , Master Ladies fly line:

Min length 13.50 m. Max length 14,6m. Max weight 34gram.

Without tolerances

U16 Boys - Min length 12 m. Max length 15,6m . Max weight 38g .

Without tolerances

U16 Girls - Minimum length 12 m. Maximum length 14,6m.

Max weight 34 gram. Without tolerances

Leader: Minimum length 1.80 metres. Maximum length 3.00 metres.

Fly: Same as event no 1.

Platform: Same as event no 1.

Court: Casting sector; width at 50 metres distance 25 metres, measured at a right angle to the perpendicular axis from the centre of the front edge of the platform.

From 50 metres wide plates are set up for orientation.

Time: Time limit 5 minutes.

Score: Longest cast to win the event in final, two longest casts added to score for combination.

1 meter = 1 point.

General: The line may be pulled out outside the court during the casting of the previous caster. The fly must lie down outside of the courts.

Corresponding to the technique of fly-distance casting, the whole fly line must be hold in the air during the forward and backward swinging.

**Event 3 Spinning Accuracy Arenberg Target**

- Rod:** Single handed minimum length 1.37 metres, maximum length 2.50 metres, at least 3 rod rings and a tip ring. Maximum diametres inside bottom ring 50 mm, tip ring 10 mm. Handle not to exceed 1/4 of rod length.
- Reel:** Open-faced spinning reel, standard spool or corresponding type.
- Line:** Unrestricted, but the same diametres in the whole length. Free running length minimum 20 metres.
- Plug:** 7.5-gram plastic, approved by the ICSF, drop-shaped with an even surface.  
 Length excluding eye: 53.0 mm plus/minus 0.3 mm.  
 Diametres of the head: 18.5 mm plus/minus 0.3 mm.  
 Diametres of the eye: 5.0 mm plus/minus 1 mm.  
 Weight of the plug 7.5 gram, plus/minus 0.15gr including eye.  
 Colour white.
- Court:** Arenberg target of green coloured ground-cloth or plastic, with 5 concentric rings marked white, maximum 2 cm, of diametres, res. 0.75 – 1.35 - 1.95 - 2.55 - 3.15 metres. The centre is a flat disc of 0.75 metres diametres, maximum thickness 10mm. and black. It should not lay deeper than the cloth.  
 5 casting stations to be arranged round the target at 90 degrees. The first and last station is in a straight line from the centre of the target over the target corner. The other three stations are placed between the first and last station. The farthest is if possible, with the wind from behind the caster. Each station marked with a starting board, 1.00-metre-long and maximum 10 cm height. Colour: white.
- Casting:** From each station 2 casts. The caster has to start from station 1 with the plug in his hand.

**Stations and casting techniques:**

Distances must be measured from centre of target and station to be cast from left to right.

Station 1: Distance 10 metres	Underhand pendulous cast.	.
Station 2: Distance 12 metres	Right-hand cast.	.
Station 3: Distance 18 metres	Over-head cast.	.
Station 4: Distance 14 metres	Left-hand cast.	.
Station 5: Distance 16 metres	Optional style cast.	.

Catapult-casts are not allowed.

Under-hand  
pendulous

cast: This is properly executed when the plug is under the rod by delivery. Any posture of the caster is allowed.

Right-hand

side cast: This is properly executed while delivering the cast the rod-tip travel at least 1 metre from the right side of the casting direction and the rod and the casting hand are to the right of the casting direction, which is the line between the centre of the caster and the target centre. The rod tip shall not travel higher than the horizontal plane when delivering the cast. Any posture of the caster is allowed, no matter if the rod is in front or behind the starting board. Dragging of the plug on the ground is prohibited and scores 0 points. Length of pendulum is unrestricted.

Over-head

cast: This is properly executed when the rod tip before the delivery is over the head of the caster. The rod has to be propelled between the horizontal and the vertical plane. Any length of overhang. Any posture of the caster is allowed.

Left-hand

side cast: This is properly executed while delivering the cast the rod-tip travel at least 1 metre from the left side of the casting direction and the rod and the casting hand are to the left of the casting direction, which is the line between the centre of the caster and the target centre. The rod tip shall not travel higher than the horizontal plane when delivering the cast. Any posture of the caster is allowed, no matter if the rod is in front or behind the starting board. Dragging of the plug on the ground is prohibited and scores 0 points. Length of pendulum is unrestricted.

Time: Time limit 5 minutes in all, moving between stations boards included.  
Time, knockout tournament: maximum of 3 minutes (Youth)

Score: From centre 10 - 8 - 6 - 4 - 2 points.  
Maximum score 100 points.

General : see knockout table pages 45,46

**Event 4**      **Spinning Accuracy**

Rod: Same as event no. 3.

Reel: Same as event no. 3.

Line: Same as event no 3.

Plug: Same as event no 3.

Targets: 5 inclined discs, diametres 0.76 metres, and maximum thickness 10 mm. Colour, yellow.  
Foremost edge 5 cm above ground and the backmost edge 17 cm above the ground.

**Court:** 5 casting stations, beginning from the left shortest distance 10 metres to centre of target, then increasing to the last target at right 18 metres to centre of target. Disc no. 2, 3 and 4 placed on a straight line between 1 and 5. Starting boards like for event no. 3. Discs to be placed and distance measured on the perpendicular from the middle of each starting board. Distance between middle of starting boards 1.50 metres.

**Court (Youth):** One target with five casting stations arranged in a straight line with the starting board placed after each other. The distance from the centre of the target to each station is 10, 12, 14, 16, and 18 metres, respectively.

For match play, courts are organized in pairs. Each pair should be positioned so that matches are easily visible and clearly separated from one another. Within a pair, the courts should be closer together than the distance between different pairs. As a general guideline, the distance between courts in a pair should be 3–5 metres, while the distance between pairs should be 5–10 metres.

The overall layout of all courts should maintain symmetry.

**Casting:** From each of the 5 casting stations to the corresponding target from each, casting two casts from each station. The caster goes through to court twice. In all 20 casts, the casting style is free, catapult cast prohibited.

**Time:** Time limit 8 minutes in all, moving between stations boards included  
Time, knockout tournament: maximum of 3 minutes (Youth)

**Score:** All hits score 5 points each. Maximum score 100 points.

**General :** see knockout table page 45,46

### **Event 5      Spinning Distance Single Handed**

**Rod:** Same as event no. 3.

**Reel:** Same as event no. 3.

**Line:** Minimum diametres 0.18 mm, (no minus tolerance allowed), but with the same diametres in the whole length. Leader minimum diametres 0.25 mm, no minus tolerance allowed. Minimum length of the leader from the reel to the plug has to be at least one complete turn on the reel. Colour of the leader: good visible like yellow, orange, neon green, black, not transparent.

**Plug:** Same as event no. 3.

**Court:** At 100 metres distance, the court is 50 metres wide, measured at a right angle to the perpendicular axis from the centre of the starting board. Starting board: 1.50 metres long and maximum 10 cm height. Colour: white.

The run for the caster is guaranteed to be maximum 5 metres.

From 50 metres wide plates are set up for orientation.

**Casting:** Each caster to have 3 casts, one in each of three rounds. Casting style is free  
Catapult casts are not allowed.

**Time:** After being called to the start, the caster has 60 seconds to step to the starting-board and to deliver his cast.

**Score:** The longest of three casts score. 1 metre = 1.5 points.

**Event 6      Fly Distance Double Handed**

**Rod:** Two-handed fly rod, maximum length 5.20 metres.

**Reel:** Same as event no. 2.

**Line:** Any line approved by the ICSF. Maximum weight: 120 grams, in whole or spliced from separate bits.

Lines with metal or similar inlays are prohibited.

Minimum length: 15.00 metres.

**Leader:** Minimum length 1.80 metres. Maximum length: 5.20 metres.

**Fly:** Same as event no. 1.

**Platform:** Same as event no. 1.

**Court:** see event. no. 2.

From 50 metres wide plates are set up for orientation

**Time:** Time limit: 6 minutes.

**Score:** Same as event no. 2.

**General:** Same as event no. 2.

**Event 7      Event 7 Spinning Distance Double Handed**

**Rod:** Any rod

**Reel:** Any open-faced spinning reel.

**Line:** Minimum diametres 0.25 mm, (no minus tolerance allowed), but with the same diametres in the whole length.

**Leader** Minimum diametres 0.35 mm, no minus tolerance allowed. Minimum length of the leader

from the reel to the plug has to be at least one complete turn on the reel. Colour: see event 1 and 5.

Plug: 18-gram plastic, approved by the ICSF, drop-shaped with an even surface. See specification

Court: Same as event no. 5.  
From 100 metres wide plates are set up for orientation

Casting: Same as event no. 5.

Time: Same as event no. 5.

Score: Same as event no. 5.

General: Same as event no. 5.

### **Event 8      Multiplier Accuracy**

Rod: Any single-handed rod, maximum length: 2.50 m

Reel: Multiplying reel with standard spool.

Line: Unrestricted, but the same diameters in the whole length. Minimum length: 22 m.

Plug: Same as event no. 7.

Targets: Same as event no. 4.

Court: Same as event no. 4. but beginning from the left shortest distance 12 metres to centre of target, increasing to the last target at the right 20 metres to centre of target.

Casting: Same as event no. 4.

Time: Time limit 8 minutes in all, moving between stations included

Score: Same as event no. 4.

### **Event 9      Multiplier Distance Double Handed**

Rod: Any rod.

Reel: Same as event no.8.

Line: Same as event no 7.

Leader: Same as event no 7.

Plug: Same as event no. 7.

Court: Same as event no. 5.  
From 50 metres wide plates are set up for orientation

Casting: Same as event no. 7.

Time: Same as event no. 5.

Score: Same as event no. 5.

General: Same as event no. 5.  
Caster has to leave the starting point within 2 minutes from the finished cast.  
Otherwise the cast will score 0.

### **Event 10      Trout Distance for Casting sport**

Rod: As per Flycasting rules for event Trout Distance

Reel: As per Flycasting rules for event Trout Distance

Line: As per Flycasting rules for event Trout Distance,

Leader: As per Flycasting rules for event Trout Distance

Fly: As per Flycasting rules for event Trout Distance

Court: Casting sector, as per ev. 2 , All competitors will cast the same direction , Courts should be built the best way with wind from back

Starting board “ .: Starting line/board length 1,5m , max. height 10cm  
Casting from ground

Time: Time limit 5 minutes , 1 round,

Score: The casts are measured from the middle of the stand to the fly. The longest cast delivered within the time limit will define the results. If two or more participants achieve the same distance, the second longest cast will decide their rankings . If still equal, the casters with the same score will cast again.

General: The line may be pulled out outside the court during the casting of the previous caster.

The fly line and running line can lay down in front of the starting line ( in the court) during the casts.

8 best boys from the qualification round and 6 girls goes to final . Based on the number of courts the final can be divided to two rounds . 4+4 boys, 3+3 girls

## **Event 11      Salmon Distance for Casting sport**

Rod: As per Flycasting rules for event Salmon Distance

Reel: As per Flycasting rules for event Salmon Distance

Line: As per Flycasting rules for event Salmon Distance  
Maximum line weight is 55g with no tolerance

Fly: As per Flycasting rules for event Salmon Distance

Leader: As per Flycasting rules for event Salmon Distance

Running line: As per Flycasting rules for event Salmon Distance

Court: ( same as event 2 ) 1 round, All competitors will cast the same direction , Courts should be built the best way with wind from back

Platform: ( same as ev2 )

Time: Time limit is 6 minutes ,

Score: The casts are measured from the middle of the stand to the fly. The longest cast delivered within the time limit will define the results. If two or more participants achieve the same distance, the second longest cast will decide their rankings. If still equal, the casters with the same score will cast again

General: The line may be pulled out outside the court during the casting of the previous caster.

The fly line and running line can lay down in front of the starting line ( in the court) during the casts.

8 best boys from the qualification round and 6 girls goes to final . Based on the number of courts the final can be divided to two rounds . 4+4 boys, 3+3 girls

## **VI. DEVIATIONS FOR LINES AND PLUGS**

Lines:	Event 1	Fly Accuracy	no minus deviation
	Event 2	Fly Distance Single Handed	no deviations
	Event 6	Fly Distance Double Handed	plus 0.2 gr deviation
	Event 5	Spinning Distance Single Handed	no minus deviation
	Event 5	Leader 0,25	no minus deviation
	Event 7	Spinning Distance Double Handed	no minus deviation
	Event 7	The leader 0.35 mm	no minus deviation
	Event 9	Multiplier Distance Double Handed	no minus deviation
	Event 9	The leader 0.35 mm	no minus deviation
Plugs:	Plastic 7.5 gr	plus/minus	0.15 gr
	Plastic 18 gr	plus/minus	0.30 gr
	Diametres of the eye	plus/minus	1.0 mm
	Plugs must not be altered in any way.		

In World and Continental Championships and by all International Tournaments sanctioned by ICSF, are only fly lines approved by the ICSF and plugs chargeable provided and controlled by ICSF allowed. Plugs for distance casting have to be distributed before the start and specially marked by the arranging organisation.

## **VII. GENERAL RULES FOR FLY-CASTING EVENTS**

### **1. Casting Techniques**

According to the specific rules for each event, the fly rod has to be used by one respectively two hands. It is allowed to achieve a fulcrum by putting the rod against the under-arm, but no fastening is allowed. All other technical aids are prohibited.

### **2. 0-point scoring - event 1,2,6,10,11:**

- a) if the rod is not handled according to the rules. In the Fly Distance Events the whole fly line must be in the air while false cast.
- b) if during the delivery the fly or the leader is missing. In case of a leader tangle the leader should be under a required minimum of 1.80 metres, the cast is scored if otherwise correct.
- c) if the caster, during the flight of the fly, touches the ground around the platform, before the fly touches the ground or the target. Events 1,2,6,11 only
- d) if the fly touches the ground or the target after the time is out,
- e) if during the false casts the fly touches the water inside the target or the ground during false casting, when final cast to score has not been delivered, Casting contrary to regulations (such as to lay down or repeatedly touching the ground with the leader or the fly line) the caster will be once warned on each target. If the caster ignores the warning the caster gets scored zero

- f) if the line is marked, or is measured along the rod by the caster
- g) if in a broken fly line tip is replaced by more than a rod length. Replacements are only allowed in the same material in the same colour.
- h) if the line in event no. 1 is pulled from the reel before the judge has given start clearance
- i) if the caster is not standing with at least one foot directly adjacent to the front edge of the platform
- j) if the fly settles outside of court (event 2,6)  
Each cast with 0 point-scoring counts for the number of casts allowed. Hits or distances achieved by illegal casts are non-scoring. If any tackle, not in conformity with regulations is being used the caster will be disqualified for the whole event.

### 3. Defect of tackle

- a) Each caster is personally responsible for using correct tackle for each event.
- b) Defects of tackle or parts of the tackle are broken or malfunction of rod or spring and defect reel.
- c) By such an event the time is stopped. The remaining time can, with a changed new tackle according to the rules, still be used, but only within the same round. Such defects have to be referred to the international judge of the court.  
**In final competitions the time stop is eliminated.**
- d) The caster will get 10 minutes to repair or change damage equipment. In final competitions the time stop is eliminated.
- e) If the fly or the leader is lost, the caster may be assisted by one person at a time, to replace the fly or the leader. The caster may have assistance in order to clear a tangle of the line, to replace a lost fly or leader or any other malfunctions of the tackle but from one person only at a time. Distances and hits before the incident count.
- f) If the hackle of the fly is separated from the hook, subject to decision of the judge, the time is stopped, and the caster or his assistant is requested to put on a new fly immediately. Time starts again as soon as the fly has been replaced, the line must be pulled in after the replacement. Unrestricted number of flies can be used.

In event no. 2 and 6.a broken fly line can be replaced by a new one, no scored 0.

### 4. Determining results

- a) The first time the fly hits the target in accuracy event must be scored for each try. In distance events the cast is measured where fly comes to rest.
- b) Casts may be repeated if there is influence by other persons. This is to be decided by the head judge after advice from the court judges.

- c) Should the fly, caused by bad floor or grass conditions, during wet fly round, hang, is it up to the international judge to decide if the caster should be given one more try.
- d) In fly events time starts when the caster declares to be ready and the judge has given start clearance. Before time is up the fly of the last cast must be resting or having touched the ground or the target in event 1 and must be delivered in events 2 and 6.
  - e) In disciplines 1, 2, 6, the casts are scored if there are no hackles on the hook.
  - f) In the finals of the fly disciplines 1, 2, 6, will be no time stop if the device breaks or there are no hackles on the hook.

### **VIII. GENERAL RULES FOR SPINNING AND MULTIPLIER EVENTS (PLUG EVENTS)**

Each caster is personally responsible for using the correct tackle for each event.

The rules for casting techniques, illegal casts, and defects of tackle as well as determining results are valid for all plug events.

#### 1. Casting Techniques

If no restrictions in the specified rules for the event are foreseen, any sporting casting techniques are allowed. Generally prohibited are so-called catapult casts, as per definition.

- a) A catapult cast is a cast in which the caster flexes his rod by holding on the plug, releasing the rod power by letting go of the plug.
  - b) Any attempt to cast in while releasing the line counts as a cast.
- #### 2. 0-point scoring – a cast is scored with 0 points:
- a) if the caster, during the flight of the plug, touches the ground in front of the starting board, or in accuracy events, is not standing with at least one foot directly adjacent to the starting board, while delivering the cast.
  - b) if the caster, in plug distance events, having entered the casting station, fails to deliver his cast before 60 seconds after the court is declared free by the judge. If this limit is exceeded, the cast counts for number of casts allowed in the event.
  - c) if the caster, in plug distance events, exceeds the prescript 5 metres run.
  - d) if the plug touches the ground inside the court or in front of the starting board or the imaginary line lengthened to both sides of the starting board, even if no cast is delivered.
  - e) if a cast is delivered, the caster having forgotten to snap over the bailing wire or line guide in spinning events, or the releasing of spool in multiplying events, even if the plug does not touch the ground.
  - f) if the bailing wire or line guide snaps to during delivery in spinning events or the spool is accidentally re-coupled in the multiplier events, even if the plug does not touch the ground.

- g) if during the flight of the plug the line breaks or was not fixed to the reel.
- h) if the plug in accuracy events hits outside the target and in distance events the plug comes to rest outside the court.
- i) if the casting technique used is not in conformity with regulations.
- j) if the caster is re-winding the line or stepping over the starting board before the cast is marked in the court or without a request of the judge.

Each illegal cast counts for the number of casts allowed. Hits or distances achieved by illegal casts are non-scoring.

If any tackle, not in conformity with regulations is being used, the caster will be disqualified for the whole event.

Any changes of the plugs will lead to disqualification for the whole tournament.

### 3. Defects of tackle

Defects of tackle or parts of the tackle are: Broken rod or spring and defect reel. Such defects have to be referred to the international judge of the court. By such an event the time is stopped. The caster gets a repairing time of 10 minutes to repair or change the tackle. In the remaining time the caster can continue with another set of tackle in conformity with regulations for the rest of the event.

No such time is given if a rod ring gets loose, line tangles or the line gets under the spool.

During all defects the caster may have assistance, from one person only at a time

**In final competitions the time stop is eliminated.**

### 4. Determining results

- a) In all plug distance events the measuring is done in metres and centimetres between the centre point of the starting board to the furthest edge of the plug. In accuracy Arenberg event scores a hit on a white ring as a hit on the immediate inner ring.
- b) Measuring of distance casts take place immediately after each cast.
- c) The judges have to announce the achieved distance of the caster immediately after each cast.
- d) Last cast must be finished before time is up, i.e. the plug must have touched target or ground (events 3, 4 and 8). In the distance events the cast must be delivered before the time is over (events 5, 7, 9).
- e) Casts may be repeated if they are influenced by other persons. This is to be decided by the head judge after advice from the court judges.

## **IX. CONDUCT OF THE CASTER**

- a) The standing of ICSF is increased according to contributions from of the casters at tournaments, like showing discipline, sporting manners and high performance. This also includes the uniform attire of the athletes. Each competitor must wear his/her starting number in a visible place during the competition. It is compulsory for each caster to act in a sporting and friendly manner and follow all advice from judges and tournament committee. Unsporting demeanour detracts from the standing of the organisation and will be punished, if continued the caster can be disqualified from the tournament.
- b) Each caster is responsible for the correctness of his tackle according to the Rules. Continuity in the casting is demanded from each caster.
- c) On tournament days training at the tournament site is possible, but only if the process of the event is not disturbed. Any caster acting against the advice from the tournament committee will be warned and if he continues to act against the advice he may be disqualified for the rest of the tournament.
- d) Each caster has to appear at the starting place on the first call. The time is running immediately after the start signal of the judge. Time to go to the starting-board and to deliver the cast in event no. 5, 7, 9: is 60 seconds when caster has been called by the judge immediately after the measuring of the previous cast. For all the events it is important that, the next following caster will be called also to be prepared for the cast or the round. Caster has to start the cast or the round immediately when the judge gives the starting signal.
- e) If in event 1 the fly line is longer than rod length by start, the judge should draw the caster's attention to this and warn the caster. If the line is not shortened after the warnings by the judge, the caster will be disqualified for the event.
- f) Each caster is obliged to follow the internationally acknowledged regulations on doping settled by ICSF anti-doping rules which are in compliance with WADA Code.

## **X. TACKLE CONTROL**

At World and Continental Championships tackle controls has to be carried out by one International judge and one assistant supplied by the arranging organisation. The control station has to be close to the courts. In the plug events there should be one person for controlling the lines on two courts. The chosen caster has to be guided with his tackle to the control station at least by a national judge. The chance to be chosen for a tackle control is 1:4. The control will be done.

All measuring devices used to measure competitors' competition equipment at world and international championships must be certified. It must be inspected and approved by an official Authority. A certificate must be presented. The measuring devices are provided by the ICSF.

**Fly-events:**

Length of the rod and rings or guides,  
 Type, length and colour of the line,  
 Weight of the fly-line in event 2, 6 and 11.  
 Length and structure of the leader, Fly, Reel  
 Marking on the line, event 10.  
 Running line diameter ev11.  
 Flootation ev11.

**Plug-events:**

Length and the rings or guides,  
 Length of the line in event 3,4,8,  
 Diameter of the line and leader (event 5,7,9)  
 Length and quality of the leader (event 5,7,9)  
 Weight of the plug  
 Reel

If the caster uses a tackle not according to the rules he will be disqualified for this event. If it should happen again, he will be excluded for the whole tournament.

**XI. OFFICIAL RECORD CASTS**

1. World and Continental records can only be registered at World and Continental Championships and at registered International Tournaments. A foreign international judge must be present.
2. If a new record has been cast, the tackle has immediately to be controlled if it is according to the Rules. This control has to be managed by an international judge. The exact time (o'clock) has immediately to be ascertained and marked in the caster's starting book or starting list, the international judge has to countersign. A foreign international judge must approve the correctness of the control.
3. In all distance events no records can be registered if the wind velocity exceeds 3 metres/second or the measuring instruments are not disposal.  
 Wind velocity to be measured at the time when the record cast was made. The place for the measuring instrument has to be close to the courts and has to be decided by the tournament committee. Measuring judges at all courts must be able to see if wind velocity is exceeded.  
 Measuring point must be between 1,8 – 2 m high.
4. The ICSF-protocol signed by at least one member of the tournament committee, has to be forwarded to the Technical Committee of ICSF to get the new record recognised.
5. Records may be cast also in the Finals.
6. At World and Continental Championships and registered International Tournaments, the actual world records have to be marked off at the court in an easily recognisable manner.

7. World - and Continental records are approved and recognised in following events:

- a) Event no. 2 Ladies and Men; Youth, Master Ladies and Men  
 Event no. 5 Ladies and Men; Youth , Master Ladies and men Event  
 Event no. 6 Men, Masters Men  
 Event no. 7 Men, Masters Men  
 Event no. 9 Ladies and Men, Master Ladies and Men  
 Event no.10 U16  
 Event no.11 U23, Ladies, Master Ladies
- b) Pentathlon Ladies and Men; Youth, Master  
 c) Heptathlon Men, Master Men  
 d) All-round Ladies and Men, Master

## **XII. EVALUATION OF THE SEPARATE EVENTS**

1. In all accuracy events points achieved = points
2. In all plug distance events metres achieved x 1.5 = points
3. In all fly distance events, the best cast counts for the individual event and the sum of the two best casts for the combination. Metres x 1.0 = points.
4. In all combinations the points scored in the individual events are added together. Sum of points decides.

## **XIII. RULES FOR INDIVIDUAL, COMBINATIONS AND TEAMS SCORING.**

At any World and Continental Championships, the following events and combinations are to be scored:

Individual score: Men	Single	events 1 to 9	
Master Men	Pentathlon	events 1 to 5	
	Heptathlon	events 1 to 7	
	All round	events 1 to 9	
Individual score: Ladies	Single	events 1 to 5 plus 8, 9, 11	
Master Ladies	Pentathlon	events 1 to 5	
	All round	events 1 to 5 plus 8 and 9	
Individual score: Youth	Single	events 1 to 5	+ev. 10 U16 or + ev.11 U23
	Pentathlon	events 1 to 5	
Team scores: Men		events 1 to 5	(4 men)
Ladies, Master		events 1 to 5	(2 ladies / 2 men)
Boys		events 1 to 5	(4 boys)
Girls		events 1 to 5	(2 girls)



b) At any sanctioned International Tournament, the following awards might be given.

1. Individual events. In each event 3 winners: 1st, 2nd and 3rd place.
2. Combination event Men. Pentathlon, 3 winners: 1st, 2nd and 3rd place.  
Master Men Heptathlon, 3 winners: 1st, 2nd and 3rd place  
All-round, 3 winners: 1st, 2nd and 3rd place.
3. Combination event Ladies. Pentathlon, 3 winners: 1st, 2nd and 3rd place.  
Master Ladies All-round, 3 winners: 1st, 2nd and 3rd place.  
If event 1 -5 & 8+9:
4. Combination event Youth . Pentathlon, 3 winners: 1st, 2nd and 3rd place.
5. Team evaluation. The best team of Men, Ladies, Youth and Master are the winners and receive a Trophy. All members including trainers of the teams are designated winners.

#### **XVI. DETERMINING THE WINNER**

1. The winner is the caster who achieves the highest points score in an individual event or combination of events.
2. Finals:
  - a) In every individual event the winner is determined by a final. The best 6 ladies and the best 8 men are qualified for the finals. In Ladies, Master ladies, Youth category at least 9 competitors must compete in the qualification round, in Men and Master Men category 12 competitors minimum. No final in case when there are less than 9 or 12 competitors in the qualification round. Determination of the winners depends on points (event 1 to 9) and time (event 1, 3, 4, 8).
  - b) All finals in the events 1-4, 6,10,11 are to be cast at the same time and in the same conditions. The finals for the plug distance events 5, 7 and 9 will take place at one court chosen by the International Chief Judge.
  - c) IF there are not 6 or 8 courts the finals will be cast in 2 rounds.
  - d) The casting courts will be taken by the caster in the reverse order of the achieved results in the qualification round, like f. ex. men division: court 1 – caster place 8, court 2 – caster place 7. If there are more casters than courts in any event, groups have to be formed-with the same number of casters beginning in the reverse order of the achieved results in the qualification round, f. ex.: 8-5 and 4-1.
  - e) The results in all finals determine the numerical order of the winners. The results of the qualification round are scored for any combination or team event.
3. Proceeding of the accuracy events 1, 3, 4 and 8:
  - a) During all accuracy rounds, the time must be taken already in the qualification round in order to determine the participants of the finals

4. Proceeding of the distance events:

- a) For the fly-distance events 2 and 6,10,11 the casting courts will be taken by the caster in the reverse order of the achieved results in the qualification round.
- b) The finals in the plug-distance events 5, 7 and 9 will be held on one court chosen by the International Chief Judge. The order of the casters will be the reverse order of the achieved results in the qualification round, place 8 to 1.

5. Same results on points of two or more casters in accuracy events 1, 3, 4, and 8:

If there are two casters or more who have the same result in the qualification round or in the finals the winner is the caster with the best result in the shortest time. If the result and the time are still the same, there will be a new final round.

6. Same results on points of two or more casters in distance events 2,6,7, 9,10,11:

If two or more casters have the same distance, the second or even the third longest cast will decide. If all three casts are the same, there will be a new final round.

7. If two or more casters have the same points score in any combination:

If two or more casters have the same number of points in any combination, the first respectively, second and third place is shared by the casters. The same rules apply for teams.

## 8. For youth

- a, For all events except 3 and 4, finals will follow rules in XVI. 2
- b, Events 3 and 4, winner will be decided by a knockout tournament.
- c, All participants will make a preliminary round. The qualification round will be performed according to the rules and point system in V. (Event 3 and Event 4 respectively)
- d, The individual score from the preliminary round will be used for scoring in any combination or teams.
- e, Knockout system
  - 1, The knockout tournament is treated as a final, rules according to finals is considered.
  - 2, Knockout system is based on normal table where seeding is based on the individual score in the preliminary round.
- 3, Qualification

The number of qualified casters who will go through to the knockout tournament is based on the number of participants according to the following table

Casters (numbers)	Through to knockout tournament
<12	Max 8
13-20	12
21-26	16
27-32	20
>33	24

4, Final rankings are determined by how far each caster advances in the knockout tournament, secondly by their seeding position.

5, Third position is decided by a match between the semi-final runners-up.

6, Event 3; The winner in an individual match will be decided by points, with time used as a tiebreaker.

7, Event 4;

- a, The winner of an individual match is the first caster to hit the target twice from each distance, for a total of 10 hits.
- b, Casting is performed in sequential order, starting from 10 metres, then 12, 14, 16, and finally 18 metres.
- c, If time runs out before any caster completes all hits, the caster with the highest number of hits will be declared the winner.
- d, If there is a tie in the number of hits, the winner will be the caster who was first to hit the target on the current station.

### **XVII. DETERMINING THE WINNERS OF THE TEAM**

1. For the team competition the results of the events no. 1 to 5 (Pentathlon) decide the team result. The team result is the sum of the added points achieved by each member of the team in each of the 5 events.
2. Winner of the team competition is the team whose members together have achieved the highest number of points.
3. If two teams or more have the same team score, the first respectively, second and third place is shared by the teams.

### **XVIII. TITLES**

1. Every starting caster has according his achieved results, the possibility to receive a World respectively Continental Championship title.
2. At all championships the winner or the winning team is designated champion of that particular event or combination of events.
3. The title to be given is: World respectively Continental Champion of the event, or the combination of events, or the team combination, with particulars of the event or the combinations and the result added.

### **XIX. HAIL THE WINNERS**

1. Hoisting of the National Flags. The sport's tournaments are subject to the Olympic Idea and are brought forward through the principle of Friendship between Nations. To express this thought, the National Flags of the participating nations are hoisted at all important international tournaments.

On demand of the organizer all participating nations should bring their flags a national anthem. The organizer can give guidelines concerning the size of the flags.

2. The winners receive in formal manner the medals in gold, respectively silver and bronze and the diplomas, showing their achieved title or place. In all events the national anthem of the winning nation is played in connection with the gold medal, when the medals have been given. In honour of the first three casters their national flags are hoisted together.

### **XX. TOURNAMENT COMMITTEE**

- a) World and Continental Championships are administrated through ICSF or by any person appointed by ICSF. It has full responsibility for the proper organisation and administration of the world and continental championships according to these international casting-sport tournament rules.
- b) The tournament committee has to have at least 5 members, 4 to be named by the country arranging the tournament. The fifth member is the international chief judge as representative of the ICSF.
- c) The head of the tournament administration is named by the country arranging the tournament.
- d) During the tournament the ICSF as organisation is represented in their controlling function by the international chief judge and his assistant. The international chief judge is nominated by the ICSF, the assistant by the organising national federation. They are responsible to the ICSF.
- e) The chief judge and his assistant are heading the international and national judges. They have to cooperate and share the duties on the fields and in the bureau. The final decision is up to the international chief judge.
- f) The chief judge and his assistant must speak English.
- g) The World and Continental Championship are officially completed, when the tournament committee and the jury have received discharge by ICSF or its representatives.

**The tournament committee is responsible to the ICSF in all its following tasks:**

- a) The technical preparations and the conduct of the events.
- b) The training and instruction of all judges.
- c) The conduct of the tournament according to the international casting tournament rules.
- d) The forming of groups in courts and the time schedule for the competitions.
- e) The controlling of the courts under the direction of the international chief judge who will acknowledge the proper conditions of the court 10 minutes before start of the particular event and report this to the tournament committee.
- f) Instructions to international (national) judges
- g) Providing facilities for training before the tournament.
- h) Correct scoring of results and records.

**XXI. MEETING OF THE HEADS OF DELEGATIONS**

At World and Continental Championships, a meeting of the heads of delegations has to be held at least the day before the official opening of the tournament. A complete starting list with the groups in courts, the time schedule and a list with the announced teams and their members have to be provided for this meeting. Changings of the start list because of illness or absence of a caster by the heads of delegations is possible.

The meeting of the heads of delegation will nominate the members of the jury.

**XXII. THE JURY**

A jury has to officiate at all World and Continental Championships as well as at all sanctioned International Tournaments. The jury at all World and Continental Championships shall have 5 members and two substitutes, none of them to cast in the tournament and at all sanctioned International Tournaments 3 members and one substitute, none of them to cast in the tournament. The members of the jury have to be present during the whole tournament. The substitutes have to replace members of the jury whose countries are involved in a protest or if one member falls ill. If there are no substitutes, a substitute has to be nominated immediately. This nomination should be done at an immediate meeting with the heads of delegations.

**Tasks of the jury:**

- a) Decide upon protests founded upon violations of the tournaments and conducting Rules, or the decisions of the judges.

- b) The jury has to be called immediately after receiving the protest and has to decide in the shortest possible time.
- c) The country lodging a protest and the country concerned are entitled to be present at the jury meeting, up to the moment of voting. Both parties have to be heard during the negotiations.
- d) Votes to be counted by simple majority.
- e) Decisions by the jury are final.
- f) In case of protests against tournament rules, the chief judge and the judge of the specific event have to give evidence before decision. Other witnesses may be called.
- g) A written protocol has to be kept about each protest and jury meeting. The original has to be sent to the Technical committee of ICSF after the tournament.
- h) The tournament committee has to be informed immediately about the handling and decisions of protest.
- i) The jury has exclusive right, after discussing the matter with trainers and team captains present, to stop casting of an event if weather conditions are severely adverse, such as thunderstorms, and order a new start.

### **XXIII. PROTESTS**

- 1. Protests against violation of tournament rules
  - a) Every caster participating has the right to appeal decisions of the judges through a protest. The protest must be forwarded in written form in English to the jury and has to be signed by the team leader or by the head of delegation.
  - b) The protest has to be forwarded within 30 minutes after finish of the event.
- 2. Protests against violation of rules concerning the conduct of the tournament
  - a) Any protests have been forwarded in written form to the jury by the head of delegation
  - b) Protests have to be decided before the tournament committee receives discharge by the ICSF

## **XXIV. OTHER RULES**

### 1. Duties and conduct of the judges

- a) In all World and Continental Championships one international judge will, in addition to the national judges, officiate at each court.
- b) International judges at World and International Championships must be uniformly equipped and colour-coordinated. The equipment must necessarily bear the inscription "International Judge" and the ICSF logo. The ICSF must determine what is included in the mandatory equipment of an international judge and provide the equipment.
- c) All functionaries (judges, secretaries etc.) are obliged to act correctly and without prejudice. They should be characterized with at least arm bands or some token of their task.
- d) In all events with time limits, the judges have to inform the caster of the time still left for the event such as the last minute, last 30 seconds and then all 5 seconds.
- e) The judge will start the event. At "Start1" time begins to run. If the time allowed is exceeded, the stopwatch has to be shown to the caster on his demand.
- f) The judges have to announce the achieved result of each cast, except during the fly distance-events 2 and 6. At continental and international championships, the result of each cast must be shown on a result-board.
- g) The judges should take a stand that they can observe the court respectively the targets and the caster, but never in front of or directly behind the targets.
- h) At any World or Continental Championships, the decision about achieved points for each cast is drawn by the international judge at the court.
- i) The judges are obliged to control the tackle according to the Rules.
- j) At World or Continental Championships, the International Chief Judge (at international tournaments a member of the tournament committee), together with the judges at the court, decides if a cast may be repeated because of undue influence by third persons.
- k) The Chief Judge is entitled to give warnings to the caster, the trainer or other people because of disciplinary misdemeanors; even to issue disqualifications. Such warnings have to be set down in the tournament protocol.
- l) At world and international championships International judges who are related to competitors must not judge at a competition nor in the championship finals.

### 2. Duties and conduct of the international chief judge:

- a) Chief Judge is responsible to the ICSF for the correct conducting of the competition on the sport-ground.

- b) Chief Judge is responsible for the national and the international judges.
- c) Chief Judge is responsible for the correct construction of the courts.
- d) Chief Judge is responsible for the tackle control.
- e) Chief Judge supervises the time schedule.
- f) Chief Judge calls the judges and casters to the courts.
- g) Chief Judge releases each event.
- h) Chief Judge calls the finalists on their new courts.
- i) Chief Judge starts and stops the finals.
- j) Only Chief Judge can issue warnings or disqualifications.

Chief judge assistant helps and supports him in all duties.

### 3. Conduct of trainers and coaches

All the trainers, persons responsible and heads of delegation have to be reachable on the sport facilities during the days of competition.

- a) It is forbidden for trainers, coaches and all other persons (casters or audience), to move into the area of the courts and to distract casters. The trainer may only give advices and information about casting technique, time, scores and conditions to his caster at any time.
- b) During the casting of all events only one assistant in the court in a time is allowed to support and to help the caster to solve problems with his equipment (rod, reel, line, leader and fly).
- c) Any misconduct or unsportsmanlike conduct may be punished by disciplinary action by the tournament committee or the chief judge, lead only by sporting principles.

## **XXV. GROUPS AT THE COURTS**

- a) The forming of groups will facilitate the organisation of the tournament and accelerate it carrying out.
- b) The forming of groups is the responsibility of the tournament committee of the arranging organization.
- c) For each event the groups could be of different size. The maximum for any group is 25 casters.
- d) No caster is allowed to cast outside his group. Starting order for the groups is regulated in start-

and timetables. Starting order for each caster inside his group must be maintained, but each group has to cast on the appointed court.

- e) Every caster in a group is personally responsible for his presence at the start. He should therefore report to the casting stations whenever he leaves the group.

#### **XXVI. OTHER RESPONSIBILITIES OF THE ARRANGING ORGANISATION**

- a) Every invitation to World and Continental Championship or to sanctioned International Tournaments must include a guarantee that the international casting tournament rules and statutes of ICSF will be followed.
- b) Events should if possible be cast in numerical order. At World and Continental Championships, the medals must be presented in the same order as the events are cast.
- c) At World and Continental Championships or at any sanctioned International Tournaments, arranging organisation has the responsibility that all casters in the same class will cast every event in the same time period and under the same conditions.
- d) At World and Continental Championships and at outdoor sanctioned International Tournaments the casting events are only allowed on grass, the grass not to be higher than three centimetres. Five centimetres is allowed during plug distance events.
- e) All side lines have to be laid out at the ground.
- f) The casters have to be provided with bibs, to be carried by the caster on their upper bodies in an easy recognizable way.
- g) All courts should, if possibly, be placed with the wind from the back.

#### **1. Start lists**

- a) The organizer prepares an identical start list with a copy for each event. This start list must contain the name of the caster, his start number and his nationality.
- b) The start lists have to be sorted after evaluation, bound together and kept together with the score sheets until the next World or Continental Championships by the tournament committee.
- c) Errors in numbers or scores have to be marked through so they are still legible and new numbers correctly marked. Any such change or correction has to be signed by an international judge in a legible way.
- d) In case of loss of the original start list the copy is binding.

## 2. **Insurance**

- a) Every caster should be careful during the casting. The courts should be safe guarded so no accident may occur to the casters or spectators. Spectators and casters not at the start must not enter any court.
- b) To be safe guarded against claims by accidents of the casters or third persons, the arranging organisation should carry insurance against accidents. At all World or Continental Championships, a physician or medical personal should be available.

## **XXVII. STARTING FEES**

For all active casters, a starting fee for each event should be paid and for each national team a booking fee. The amount has to be decided by ICSF together with the arranging organization.

This money is for the covering of costs for the international judges appointed by the Technical Committee of ICSF during World- or Continental Championships.

At World and Continental Championships every participating nation is obliged upon demand by the arranging organisation to participate with one international judge. The travelling costs to be covered by the nation and the accommodation costs by the arranging organisation.

BERLIN, GERMANY	, JANUARY 29,	1994
Revised DÜBENDORF, SWITZERLAND	, JANUARY 21,	1995
Revised NOVE ZAMKY, SLOVAKIA	, JANUARY 14,	1996
Revised STOCKHOLM, SWEDEN	, JANUARY 26,	1997
Revised NOVE ZAMKY, SLOVAKIA	, JANUARY 29,	2000
Revised BERLIN, GERMANY	, JANUARY 27,	2001
Revised by Dr. R. Schuster, I.C.F. Board and FCS Board	, FEBRUARY,	2002
Revised VIENNA, AUSTRIA	, APRIL 13,	2003
Revised MALMÖ; SWEDEN	, SEPTEMBER	2007
Revised PRAG CZECH REPUBLIC	, APRIL	2009
Revised PRAG CZECH REPUBLIC	, NOVEMBER	2009
Revised VIENNA, AUSTRIA	, APRIL 10,	2011
Revised HALLE, GERMANY	, SEPTEMBER 11,	2013
Revised BERLIN, GERMANY	, OCTOBER 24,	2015
Revised BERLIN, GERMANY	,NOVEMBER 26,	2016
Revised Pulawy, Poland	,JULY 21,	2018
Revised VIENNA, AUSTRIA	, NOVEMBER 17,	2019
Revised PRAGUE CZECH REPUBLIC	,APRIL 3,	2022
Revised by BOARD meeting	AUGUST 7,	2024
Revised BUDAPEST ,HUNGARY	NOVEMBER 29,	2025

XXVIII. DRAWINGS

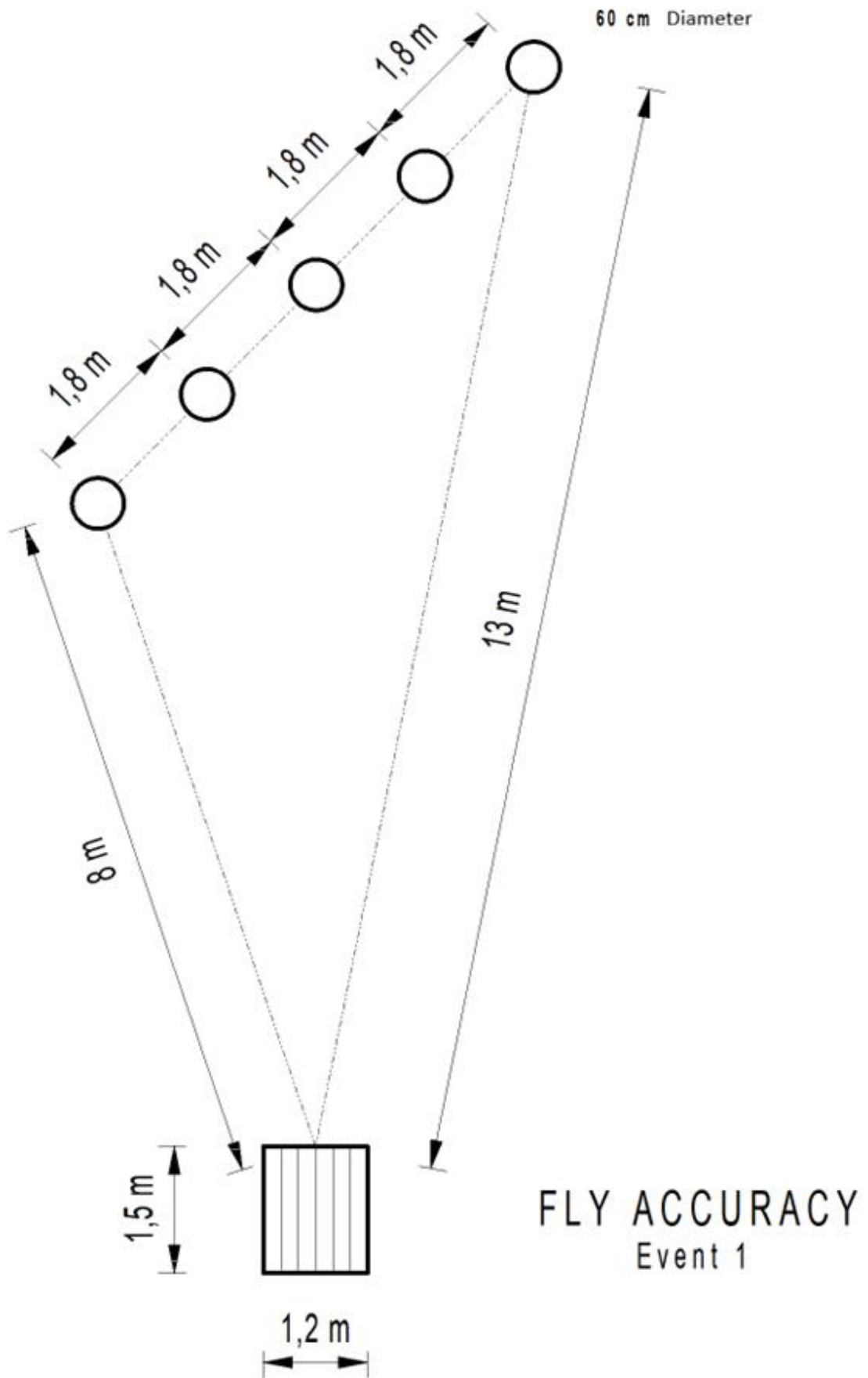

35

50 m

103,08 m

100 m

1.5 m

1.2 m

# FLY DISTANCE

Event 2

Event 6

Event 11

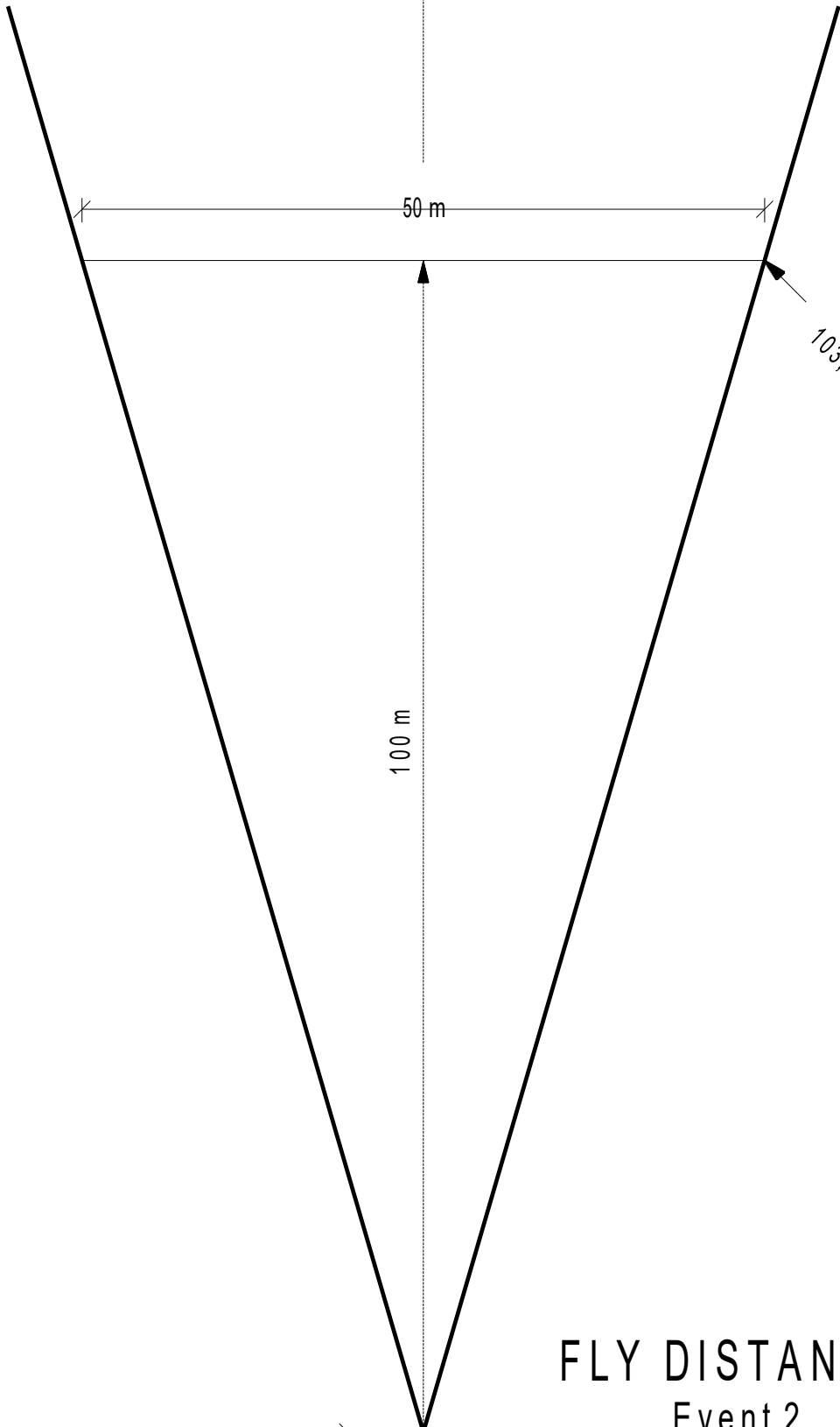

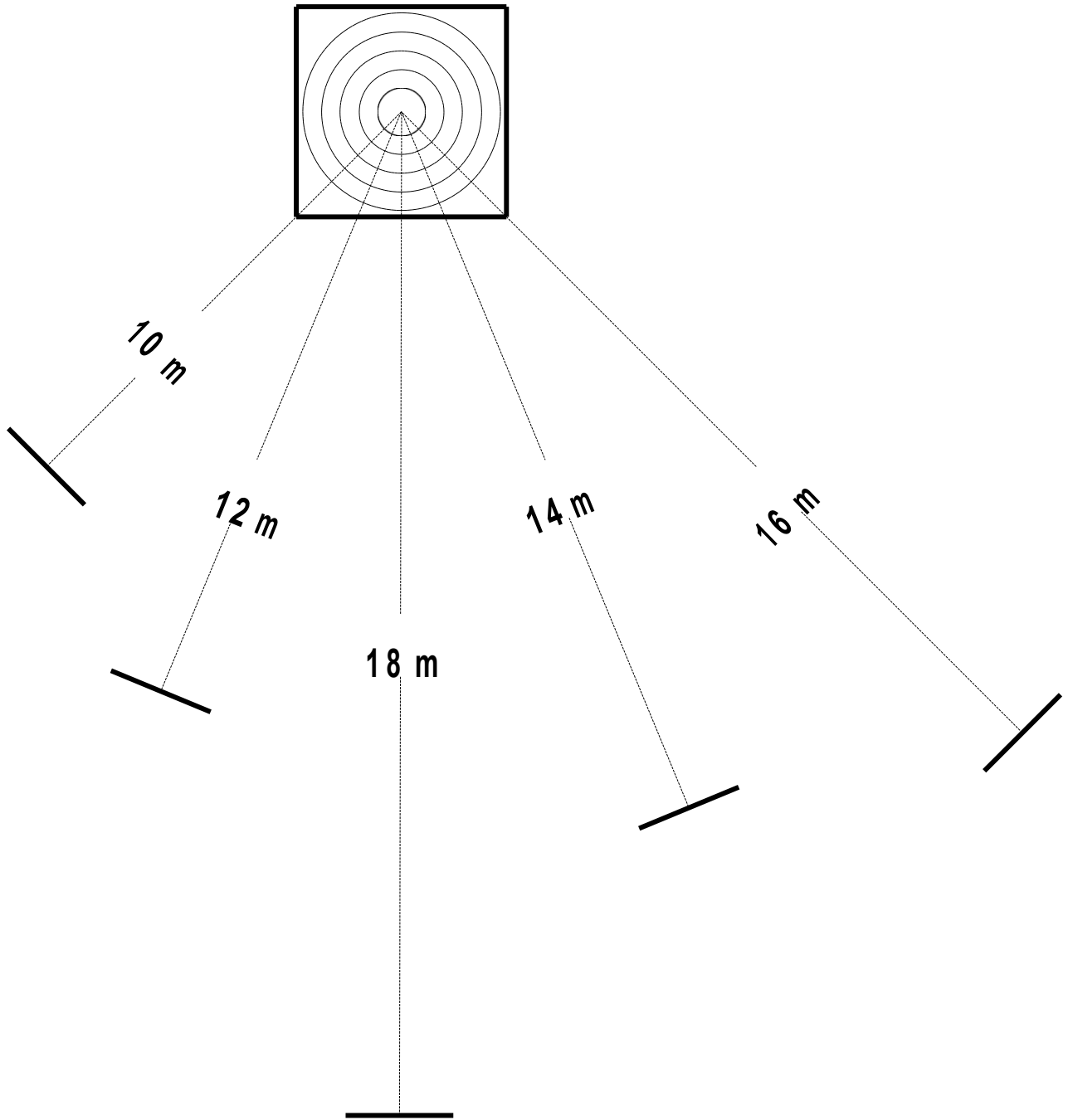

SPINNING ACCURACY ARENBERG TARGET  
Event 3

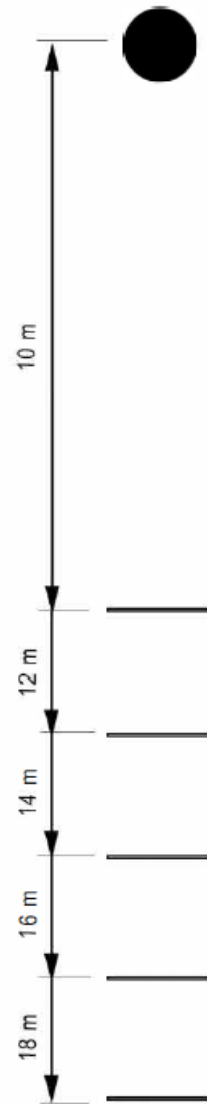
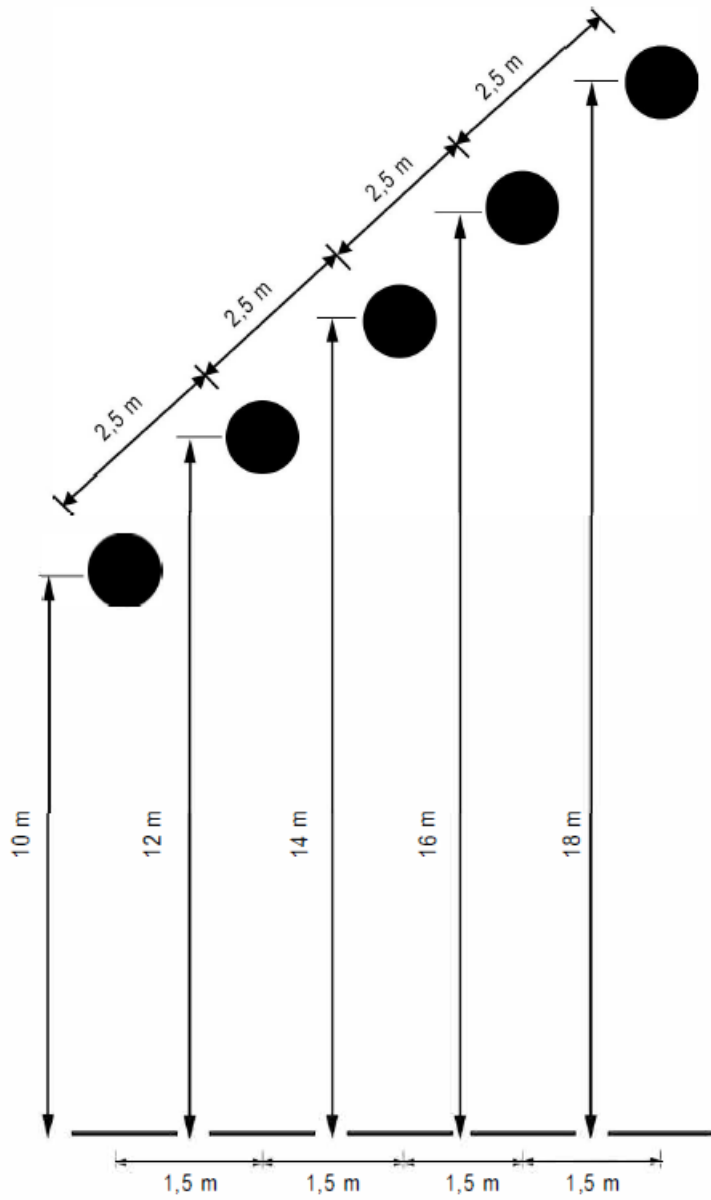

Youth Layout

### SPINNING ACCURACY Event 4

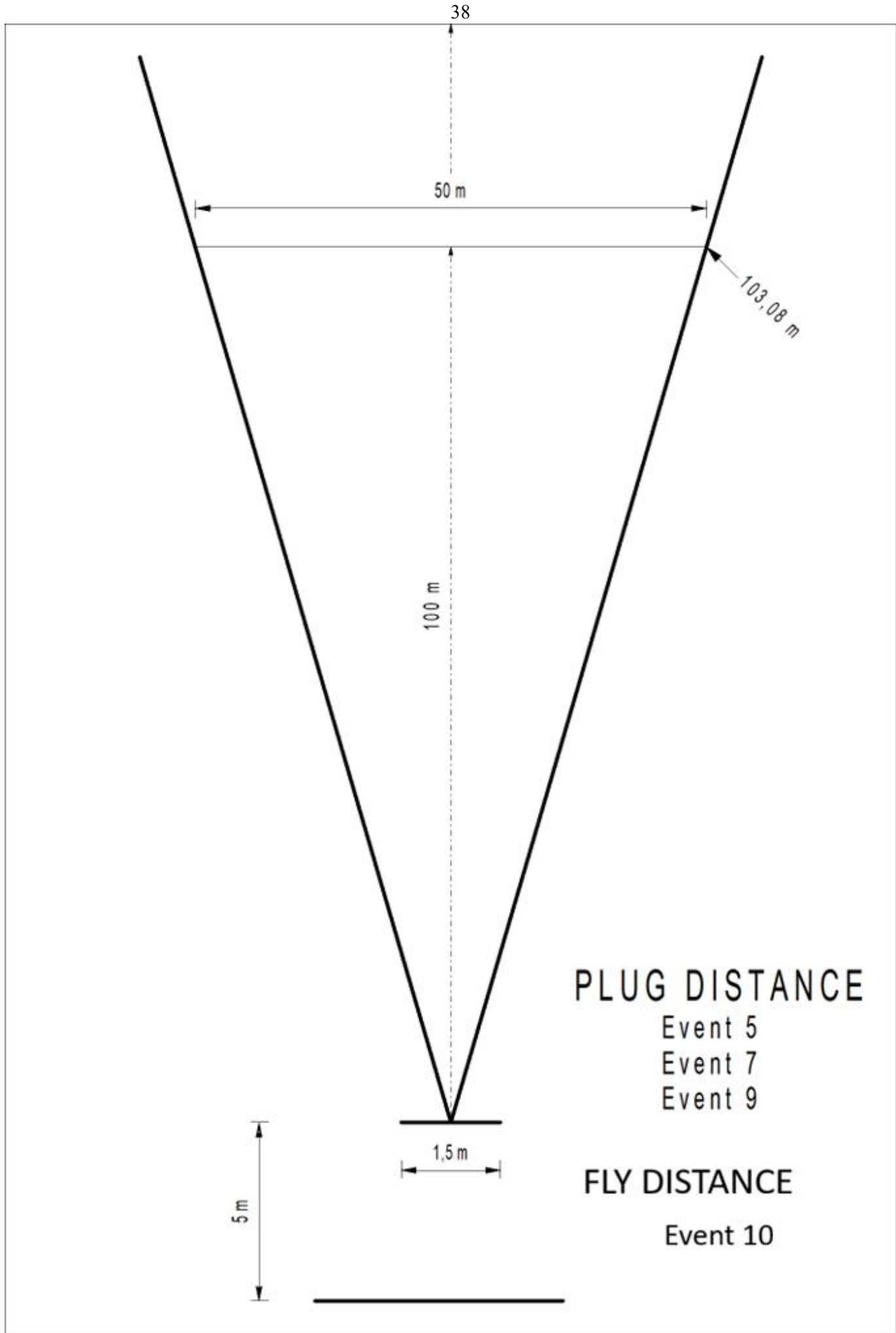

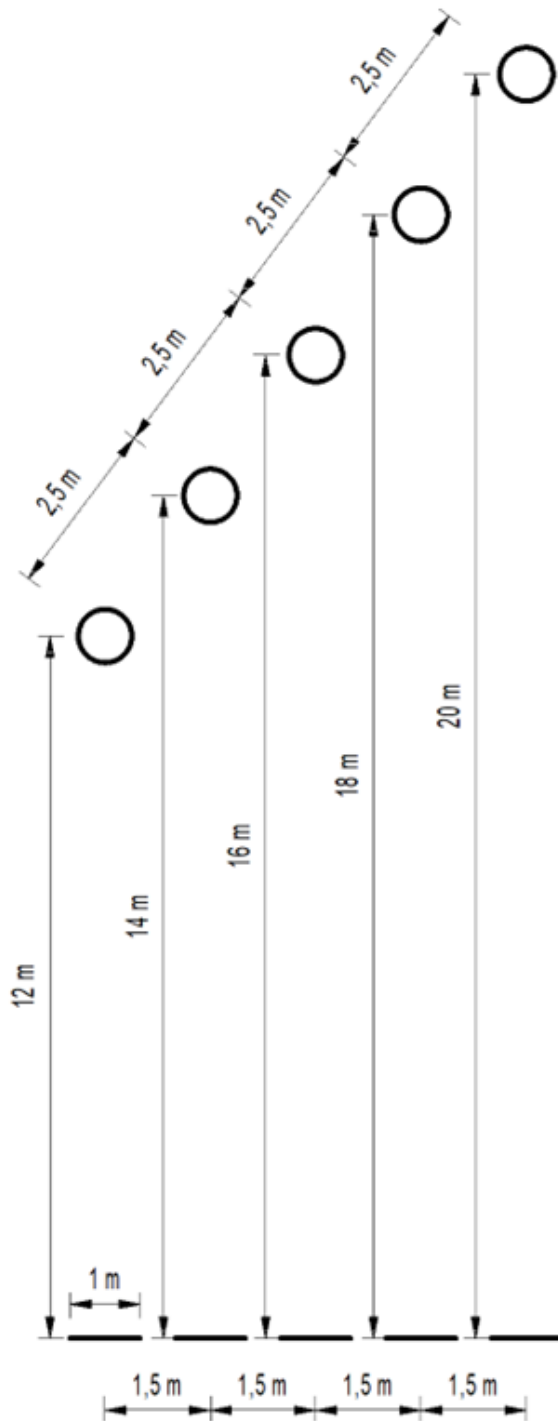

## MULTIPLIER ACCURACY

Event 8

## 7.5 gr Plug

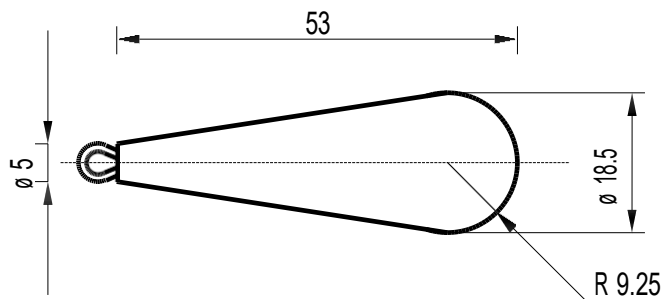

### Deviation

Length	+/- 0,3 mm
Diameter of the head	+/- 0,3 mm
Diameter of the eye	+/- 1 mm
Weight	+/- 0,15 gr.
Colour	white

all dimensions in mm.

# 18 gr Plug

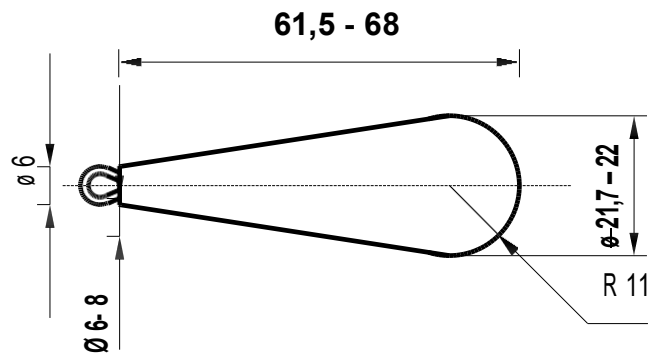

## Deviation

<b>Length without eyelet</b>	<b>+ / - 0,5 mm</b>
<b>Diameter of the head</b>	<b>+ / - 0,5 mm</b>
<b>Diameter of the eye</b>	<b>+ / - 1 mm</b>
<b>Diameter at the eyelet</b>	<b>+ -0,5</b>
<b>Weight</b>	<b>+ / - 0,3 gr.</b>
<b>Colour</b>	<b>white</b>

all dimensions in mm.



## EVENT 1 FLY ACCURACY

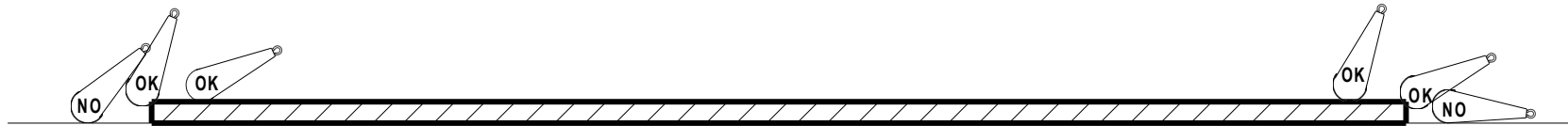

### EVENT 3 SPINNING ACCURACY ARENBERG TARGET

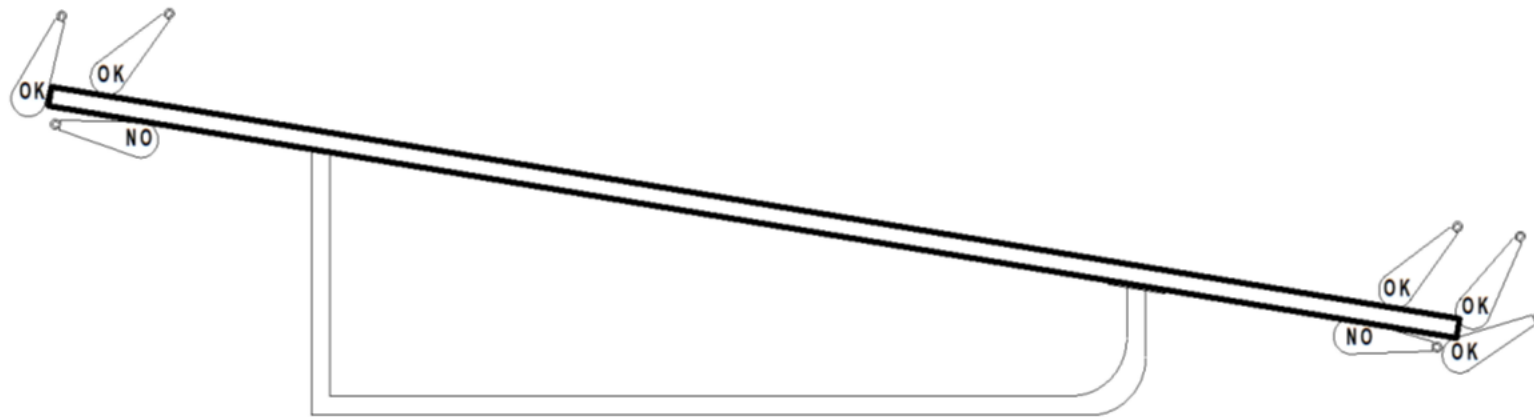

**EVENT 4      SPINNING ACCURACY**

**EVENT 8      MULTIPLIER ACCURACY**

### Knockout Table 24 Casters



### Knockout Table 16 Casters



## Knockout Table 12 Casters

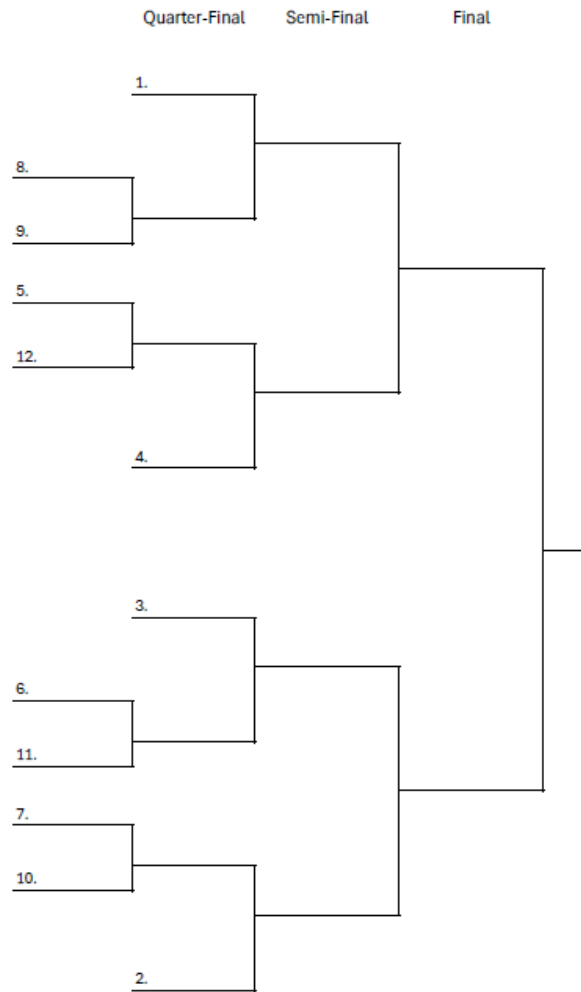

## Knockout Table 8 Casters

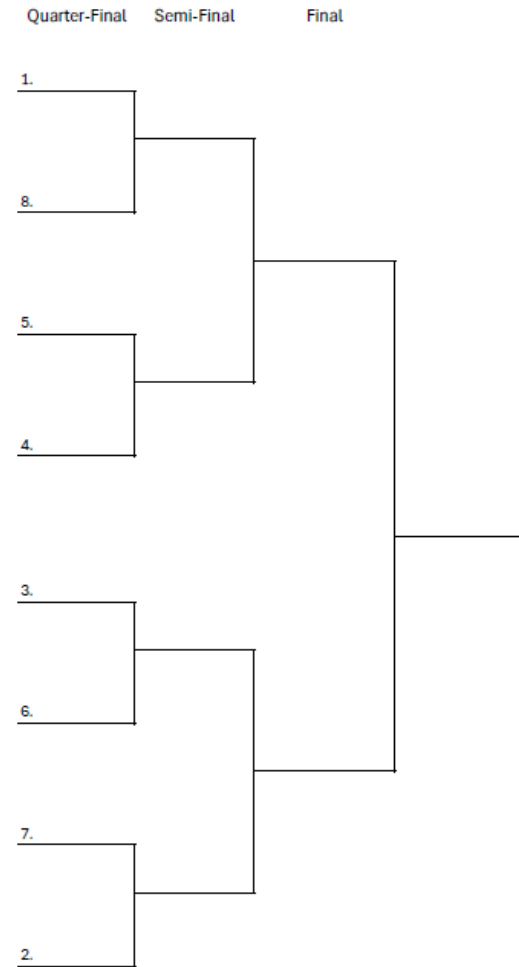



## **Approved Fly lines**

**Valid 1. 1. 2026**

**Fly lines approved by ICSF for an International  
Tournaments, events no. 1,2,6**

**All approved lines must follow the International Tournament Rules**

## Event 1 Fly Accuracy:



Fly Accuracy

**Manufacturer:** SCIENTIFIC ANGLERS 3M  
**Country:** USA  
**Colour:** Yellow/orange  
**Marking:** T-38 and T40

## Event 1 Fly Accuracy:



Fly Accuracy

**Manufacturer:** HUGO WEINERT

**Country:** Germany

**Colour:** Yellow, Green

**Marking:** Own brand

## Event 1 Fly Accuracy:



Fly Accuracy

**Manufacturer:** SCIENTIFIC ANGLERS 3M  
**Country:** USA  
**Colour:** Yellow  
**Marking:** WF-10-F

## **Event 1 - Fly Accuracy**

**( Approved for Master category ev.no2 Fly  
Distance Single Handed)**



Fly Accuracy

**Manufacturer: AIRFLO**  
**Country: England**  
**Colour: Yellow/orange**  
**Marking: C-7PH-T38-FO**

## **Event 1 and 2 Fly Accuracy & Fly Distance Single Handed**



Fly Distance Single Handed  
Fly Accuracy

**Manufacturer: BFL Manufacturing Ltd.U.K**  
**Country : UK**  
**Colour: Yellow**  
**Marking : T38-B27 ;T38-B40 ; T34-B24**

## Event 6 Fly Distance Double Handed



Fly Distance Double Handed

**Manufacturer:** AIRFLO  
**Country:** England  
**Colour:** Yellow/orange  
**Marking:** C-7PH-T120-FO